

# Driving Directions

## Primary Care Westerville



THE OHIO STATE UNIVERSITY

WEXNER MEDICAL CENTER

### From the North (Cleveland)

Take any major highway to Interstate 71 S  
Take exit 121 for Gemini Place toward OH-750/Polaris Parkway  
Turn left onto Gemini Place  
Turn right onto Worthington Road  
Use the left two lanes to turn left onto Polaris Parkway  
Turn right at the first cross street onto N Cleveland Avenue  
Turn right onto Westar Crossing and turn left

### From the South (Cincinnati)

Take any major highway to Interstate 71 N  
Use the right three lanes to take exit 121 for OH-750  
Use the right lane to turn right onto Polaris Parkway  
Turn right onto Orion Place  
Turn left onto County Line Road W  
Turn left onto Executive Campus Drive  
Turn right onto Westar Crossing and turn left

### From the East (Zanesville)

Take any major highway to Interstate 70 W  
Use the right two lanes to take exit 108 for I-270 N  
Keep left and merge onto I-270 N  
Take exit 27 toward Cleveland Avenue and keep right  
Use the right two lanes to turn right onto Cleveland Avenue  
Turn left onto Westar Crossing and turn left

### From the West (Dayton)

Take any major highway to Interstate 70 E  
Use the right two lanes to take exit 93 to merge onto I-270 N  
Use the right two lanes to take exit 27 for Cleveland Avenue  
Use the left two lanes to turn left onto Cleveland Avenue  
Turn left onto Westar Crossing and turn left



North

Not to scale

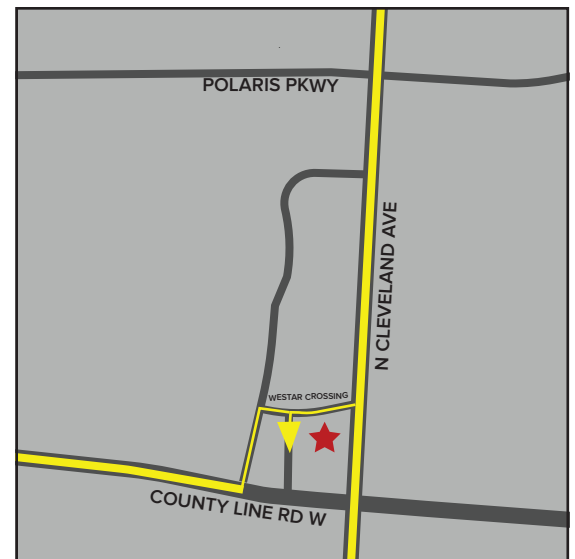

### ★ Primary Care

465 N Cleveland Ave, Suite 210  
Westerville, OH 43082  
614-293-3939

 For directions assistance call  
614-293-8000  
wexnermedical.osu.edu

 The Ohio State University Wexner Medical Center is committed to improving people's lives. That's why all medical center locations inside and outside are tobacco-free. This includes all tobacco products, including cigarettes, cigars, chewing tobacco and pipe tobacco.